

ECULED212



ECULED212 For LED Luminaires/ LED Modules

Specifications

Input	230 Volt AC, 50/60 Hz, max 0,025A
Power Consumption	max 5VA
Operating Mode	Non-maintained
Function	Standard & Self Test (XX-ST models)
Luminaire	LED light source
Battery	High Temp Ni-Cd batteries
Emergency Duration	1 or 3 hours
Charge Indicator	Green LED lamp
Fault Indicator	Red LED lamp (Self Test models)
Output Voltage	Refer to table below
Insulation Class	Class II (no earth wiring required)
Protection Class	IP20
Temperature	ta 0-45°C
Terminals	0.2 to 1.5mm ² quick fit terminal block
Enclosure	White thermoplastic housing



Dimensions (mm)

ECULED212

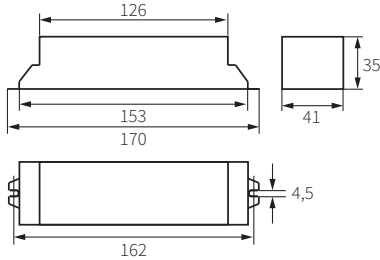

ECULED212F

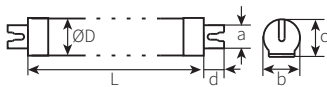
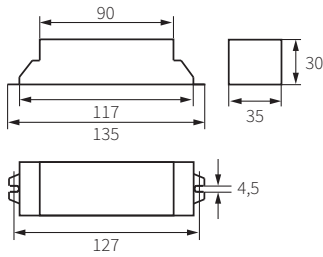

Battery	ØDxL	a	b	c	d
3.6V - 0.8Ah	15x150	12	18	16	6
3.6V - 1.7Ah	23x130	17	27	27	14
3.6V - 3.0Ah	26x150	19	30	30	8
3.6V - 3.5Ah	26x180	19	30	30	8
3.6V - 4.5Ah	33x190	25	37	37	16
4.8V - 1.7Ah	23x170	17	27	27	14
4.8V - 4.5Ah	33x240	25	37	37	16
6.0V - 1.7Ah	23x220	17	27	27	14
6.0V - 4.5Ah	33x290	25	37	37	16

(*) Special type & configurations are available

Ordering Details

ECU212F Series

Code	Output	Type	Battery		Duration	Ouput Power
			Type	Volt-Ah		
ECULED212-65F-1H	5-55V	ECO	Ni-Cd	3.6V-0.8Ah	1H	1,00W
ECULED212-65F-3H				3.6V-1.7Ah	3H	1,00W
ECULED212-65HF-1H				3.6V-1.7Ah	1H	2,40W
ECULED212-65HF-3H				3.6V-4.5Ah	3H	2,50W
ECULED212-65UF-1H				4.8V-1.7Ah	1H	3,25W
ECULED212-65UF-3H				4.8V-4.5Ah	3H	3,40W
ECULED212-120F-1H	60-120V	ECO	Ni-Cd	4.8V-0.8Ah	1H	1,50W
ECULED212-120F-3H				4.8V-1.7Ah	3H	3,25W
ECULED212-120HF-1H				4.8V-1.7Ah	1H	1,30W
ECULED212-120HF-3H				4.8V-4.5Ah	3H	3,40W

ECU212 Series

Code	Output	Type	Battery		Duration	Ouput Power
			Type	Volt-Ah		
ECULED212-65E-1H	5-55V	ECO	Ni-Cd	3.6V-0.8Ah	1H	1,00W
ECULED212-65E-3H				3.6V-1.7Ah	3H	1,00W
ECULED212-65-1H				3.6V-1.7Ah	1H	2,40W
ECULED212-65-3H				3.6V-3.0Ah	3H	1,70W
ECULED212-65-ST-1H				SELF TEST	Ni-Cd Ni-MH	4.8V-1.7Ah
ECULED212-65-ST-3H	4.8V-3.0Ah	3H	2,25W			